

Rapid Hawk Muffler Retrofit Kit

Assisted Tube Rolling System

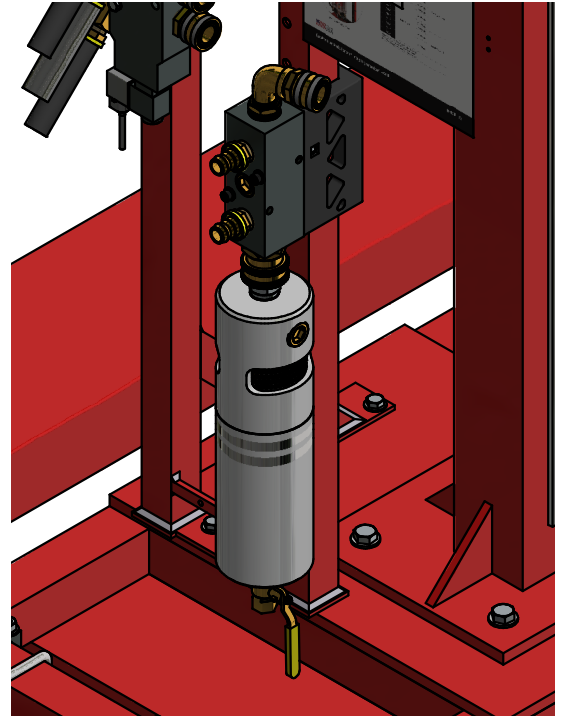

Muffler Retrofit Installation Instructions

This page intentionally left blank.

RAPID HAWK OIL CATCH MUFFLER INSTALLATION

Stock Muffler/Shroud Removal

1. Remove (2) wing nuts (Item 29) located at the bottom of the muffler box (Item 26).
2. Remove (2) Hex Head Cap Screw (Item 22) and lift muffler assembly to remove from the muffler box.
3. Remove muffler/shroud assembly from manifold (Item 45).
 - Use 1-1/16" box wrench or adjustable wrench remove the reducing nipple (Item 47) from the bottom of the manifold (Item 45)
4. Remove muffler box (Item 26).
 - Reach through the bottom holes of the muffler box using a 3/16" Hex Key to remove (2) socket head cap screws (Item 28)

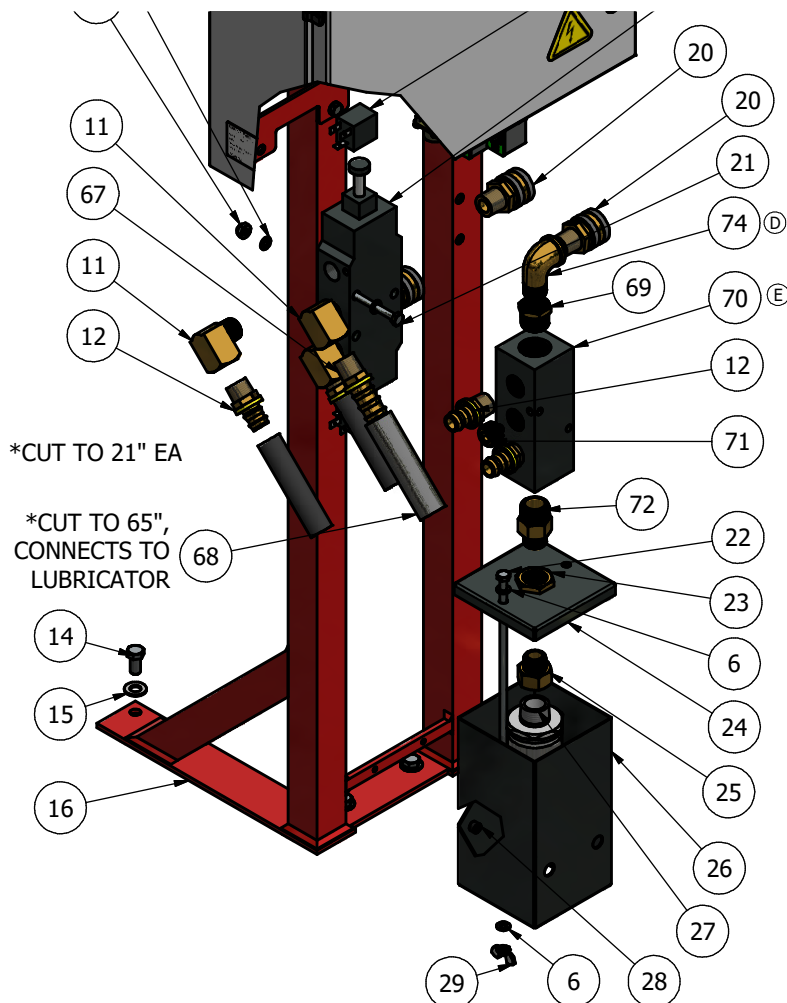

RAPID HAWK OIL CATCH MUFFLER INSTALLATION

Oil Catch Muffler Installation

1. Install $\frac{3}{4}$ Quick Disconnect Hose Coupling (P3) to the Manifold.

- Disconnect the P3 from the top of the muffler
- Using 1-7/16 wrench or adjustable tighten P3 into the bottom of the manifold (Item 45).
Note: Apply thread sealant to the male NPT on the hose coupling prior to assembly

2. Install Mount (P2).

- Remove (2) Socket head cap screws from the mount
- Place mount so that it straddles the rail and hand tighten the cap screw
- Slide the mount up the rail so that it sits just below the intake hoses. Tighten the (2) socket head cap screws using a 3/16" Hex Key

3. Mount the manifold to the Mount (P2).

- Adjust elbow (Item 50) at top of manifold so that it is oriented 90 deg to the (2) hoses
- Align the (2) holes in the Manifold with the mounting holes on the Mount
- Install using the supplied $\frac{1}{4}$ -20 socket head cap screws and 3/16" Hex Key

4. Connect the Muffler (P1) to the $\frac{3}{4}$ Quick Disconnect Hose Coupling (P3).

- Reach through the bottom holes of the muffler box using a 3/16" Hex Key to remove (2) socket head cap screws (Item 28)

Parts To Be Installed			
Item	Part Number	Description	Qty
P1	PTR1100	Muffler	1
P2	PTR1102	Mount	1
P3	41-6537K66	$\frac{3}{4}$ Quick Disconnect Hose Coupling	1

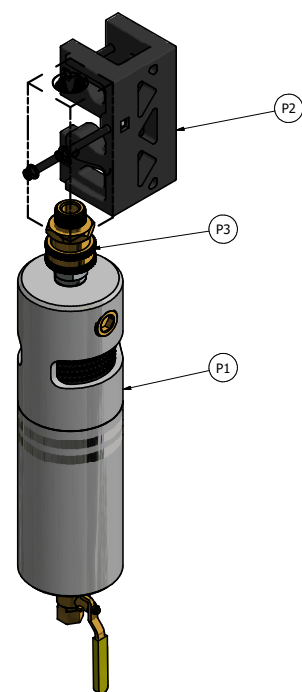
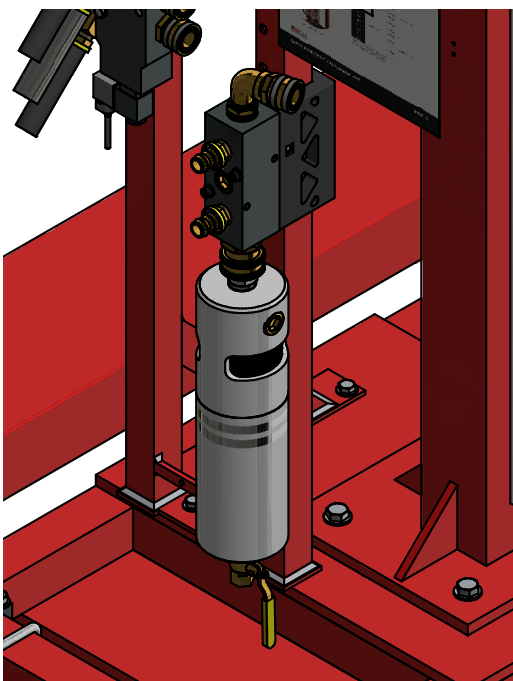

RAPID HAWK OIL CATCH MUFFLER INSTALLATION

Operation

1. It is recommended to check and drain the Oil Catch Muffler after 20 hrs of use. Note service intervals will vary based on oil lubrication setting. Faster drip rates will require decreasing the time between service whereas slower drip rates will prolong the service life.
2. There are several ways to Drain the oil from the Oil Catch Muffler.
 - Place a container under the bottom of the can and open the drain valve
 - Attach a hose to the 3/8 NPT located on the drain valve and run the hose to a preferred draining location. Open the valve.
 - Quick disconnect the muffler, place over container, and open drain valve.

This page intentionally left blank.



**Scan for more information or visit:
elliott-tool.com/rapidhawk**

©2024 Elliott Tool Technologies, Ltd.
1760 Tuttle Ave, Dayton, Ohio 45403
+1 800 332 0447
TM-151
PL-131